



Components not to scale.

Description	Qty
Grab Bar	2
Grab Bar Support (Left Hand)	1
Grab Bar Support (Right Hand)	1
Grab Bar Support Screw	8

**Tools:**

7/16" Socket, Wrench, or Drill Driver Attachment.

**NOTICE****High-Low Table is Featured**

These instructions feature an Access High-Low Exam Table. The process for replacement or repair of an Access Flex Exam Table will be the same.

The Brewer Company, LLC  
N88 W13901 Main Street, Suite 100  
Menomonee Falls, WI 53051  
P 1.888.Brewer.1  
F 262.251.2332  
[www.brewercompany.com](http://www.brewercompany.com)

### Grab Bar Removal:

Remove Grab Bar by:

1. Rotating 90° to the table and,
2. Lift grab bar up.

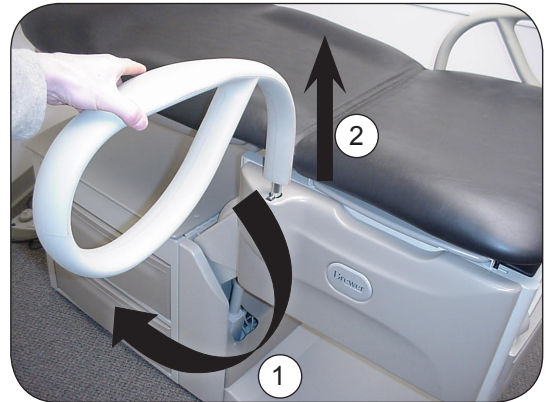

### Decorative Side Shroud Removal:

1. Remove the front drawer:
  - a. Pull the front drawer out until it stops.
  - b. Located on the underside of the drawer, in the drawer slide, at the point where the slide enters the table is a plastic locking tab. Move and hold the tab on both drawer slides to the left.
  - c. Pull the drawer out. There will be some resistance. Pull hard enough to overcome the resistance.
  - d. Set drawer aside.

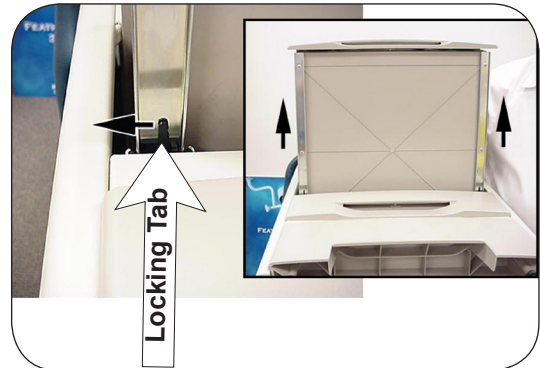

View of Drawer Underside

#### NOTICE

The screws that secure the Decorative Side Shrouds to the table are located in the places indicated. Use these reference locations when performing the following steps.

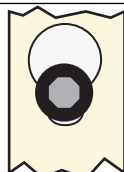

Keyhole Slot with Screw Head

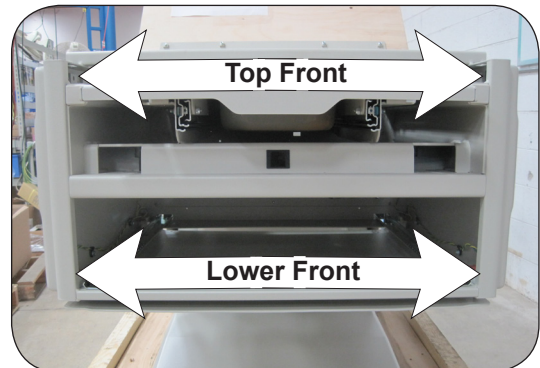

Decorative Side Shroud Screw Locations

#### NOTICE

Table shown without upholstery for clarity.

2. Loosen the Decorative Side Shroud screws 1 turn as follows
  - a. Loosen top front screw on the left and right sides.

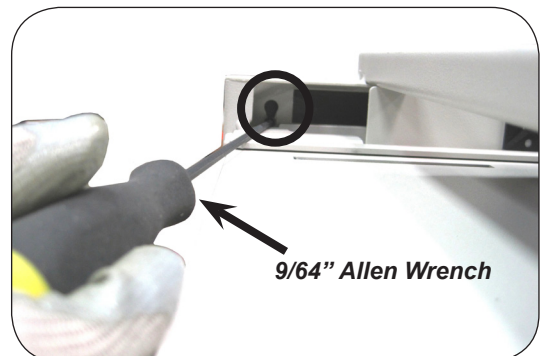

- b. Loosen the lower front screw on the left and right side

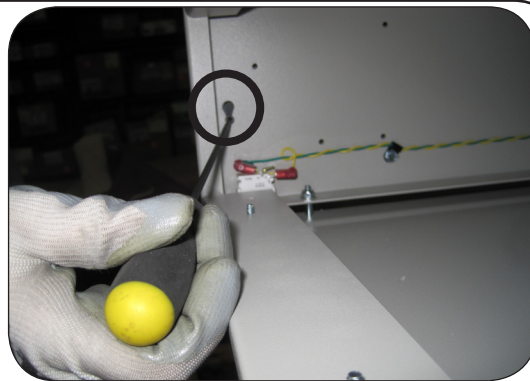

**NOTICE**

Top rear screws are located on the back of the seat cabinet section opposite top front screws.

- c. Loosen the upper rear screws on the left and right sides.



3. Remove the Side Covers by lifting upward on the Cover and pulling away from the table.



**Grab Bar Supports Replacement:**

**NOTICE**

Grab bar supports should be replaced to ensure that the new grab bars will fit properly.

1. Remove the Grab Bar Supports on both sides.
2. Install new Grab Bar Supports that came with kit. Note: the hole patterns in the Supports prevent incorrect attachment when the locking notch is oriented upward.



### Side Cover Install:

1. Re-attach Side Cover by inserting the four screw heads on the Side Cover into the four keyhole openings on the exam table frame. Push straight down on the Side Cover until the four screw heads are fully seated in the keyhole openings.
2. Tighten screws (reverse of step 2 of “Decorative Side Shroud Removal”).

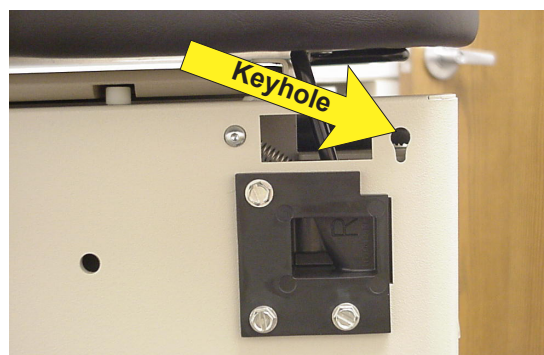

### Reinstall Front Drawer

1. Before replacing the drawer, slide the ball bearing glide track all the way forward inside the table .
2. Align the drawer guides on both sides, press ends of drawer slide half attached to drawer into the Front Catch on slide half in drawer opening.
3. \*Keep drawer level to ensure engagement of Ball Bearing Glide Tracks, and slide into opening.
4. Pull out and push in to ensure proper operation.



Front Catch

*Slide Ball Bearing Glide Tracks Forward*

\*If Ball Bearing Glide Tracks do not engage, retry starting at Step 1 of this section.



**Reinstall Grab Bars**

1. Insert the grab bars 90° to the table. Dowel pin on grab bars fit into the groove located on the table side cover. Push down until fully inserted.

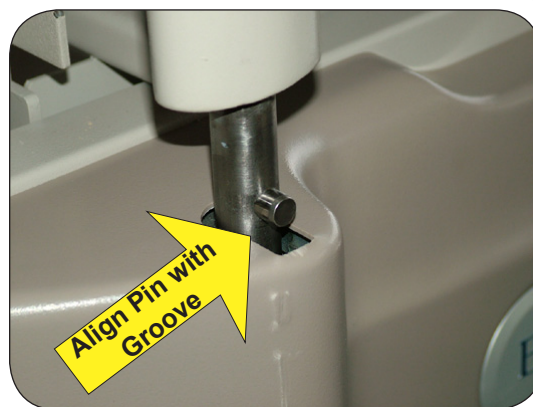

2. Swing forward to lock into position.

